

Short Road, London, W4 2QU

£860,000

**WHITMAN & CO.**

SALES · LETTINGS · COMMERCIAL

- Large loft
- Newly refurbished to a high standard
- Private patio garden
- Two double bedrooms
- Tree-lined cul-de-sac
- No chain

Tenure - Freehold  
Local Authority - Hounslow  
Council Tax - Band F

## THE PROPERTY

A charming, newly refurbished Victorian cottage tucked behind Chiswick House and Grounds in a tree-lined cul-de-sac. The property offers two double bedrooms, a large loft, a luxury bathroom, a 22' through reception room, a 17' fully integrated bespoke kitchen/breakfast room, and a private patio garden. Immaculate condition throughout. Ideally located within close proximity to rail, bus, and tube transport, as well as Riverside walks, Chiswick House Grounds, and the extensive amenities of Chiswick High Road. No onward chain.

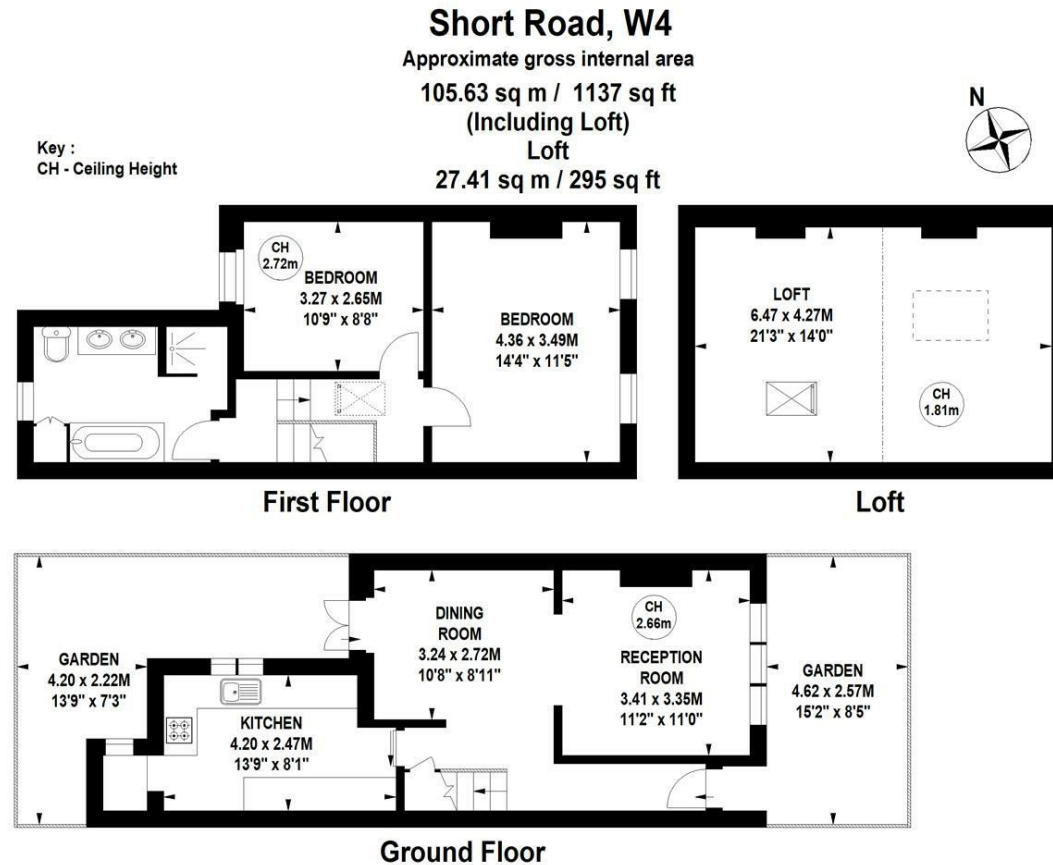

Not to scale, for guidance only and must not be relied upon as a statement of fact.  
All measurements and areas are approximate only

## SITUATION



5-7 Turnham Green Terrace, Chiswick, London, W4 1RG

Tel 020 8747 8800

E-mail [sales@whitmanandco.com](mailto:sales@whitmanandco.com)

Website [www.whitmanandco.com](http://www.whitmanandco.com)